



**Scale Motorsport**  
 3 Topside Lane  
 Newtown, CT 06470-2023

Phone: 203.426.9686  
 Fax: 203.426.1397  
 Email: scalemotor@aol.com  
 www.scalemotorsport.com  
 © Scale Motorsport 1999

This product is not a toy,  
 it is designed for the  
 advanced builder or  
 intermediate modeller  
 interested in learning new  
 techniques while expanding  
 their modelling skills. Not  
 safe for children under the  
 age of 12 years.

Don't forget to look for other Scale Motorsport Rally  
 Photoetch and Templated Composite Fiber Decal  
 sets for all the Tamiya Rally Cars:

Subject	Photoetch Sets	Template CF Decal Sets
Mitsubishi	3010	7010
Toyota Corolla	3015	7015
Ford Focus	3020	7020
Peugeot 205	3025	7025
Subaru 1999 WRC	3026	7026
Subaru 2001 WRC	3027	7027

We will continue to release more sets as the Tamiya Rally series grows!

## Peugeot WRC Photoetch Instructions

1. Front brake discs goes on parts B7 B8
2. Front logo grill
3. Fuel Filler goes on part C14
4. Rear brake disc shields goes on parts C8 C9
5. Hood pins
6. Rear brake discs goes on parts C8 C9
7. Dash board unit replaces decal 67 on part B10 or PE part 15
8. Hood vent
9. Hood clips
10. Roof detail replaces part C1
11. Rear tow hook replaces part C39
12. Front tow hook replaces part C38
13. Rear logo badge replaces decal 65
14. Hood air scoop grill goes on part C3
15. Goes on part C14
16. Hood grill
17. Grill replaces part C11
18. Front grill replaces mesh A B
19. Replaces decal 75
17. Attach to part C24
18. Attach to part C24
19. Attach to part C23
20. Fuel tank straps goes on part C14
21. Radiator grill goes on part C23
22. Radiator grill goes on part C23
23. Radiator grill goes on part C22
24. Front grill replaces mesh C
25. Mirrors replaces D1 D2
26. Licence plates replace decals 40 41
27. Fuel tank detail goes on part C14
28. Replaces decal 74
29. Dash board unit replaces decal 68
30. Front hub details goes on parts B7 B8

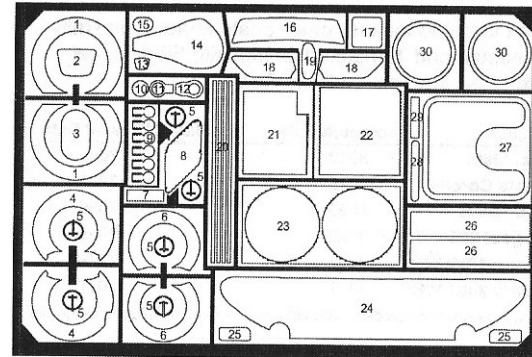

### Hood Latch Assembly

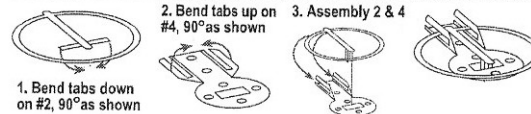

1. Bend tabs down on #2, 90° as shown

2. Bend tabs up on #4, 90° as shown

3. Assembly 2 & 4